



Lochinvar[®]
High Efficiency Water Heaters, Boilers and Pool Heaters

**POWER VENTED GAS
WATER HEATER
Submittal Sheet**

LVN-Sub-05

POWER VENTED RESIDENTIAL GAS WATER HEATERS

JOB NAME _____
LOCATION _____
ARCH./ENGR. _____
WHOLESALE _____
MECH. CONTRACTOR _____
MODEL NO. _____
TYPE GAS _____
Btu/hr INPUT _____
RECOVERY RATE IN GPH _____ **@** _____ **°F RISE**
GALLON CAPACITY _____
NOTES

Standard Features

- Power Vented Exhaust System
- Side Wall or Vertical Venting
- Electronic Spark Ignition
- Low NOx Burner
- Non-CFC Foam Insulation
- Glass-Lined Steel Tank
- Magnesium Tank Saver Anode
- Factory Installed Heat Trap Nipples
- Electronic Thermostat
- Side Connections for Space Heating
- Temperature & Pressure Relief Valve
- Brass Drain Valve
- 6 Year Limited Warranty*
(See warranty for details)
- 10 Year Extended Warranty Available
(In residential applications)

* 3 year limited warranty on tank and 1 year limited warranty on Parts
when installed in commercial applications

Options

Place an X in the box by all options that apply

Aluminum Anode Rod
10 Year Limited Tank Warranty

Power Vented Residential Gas Water Heater Dimensions & Specifications

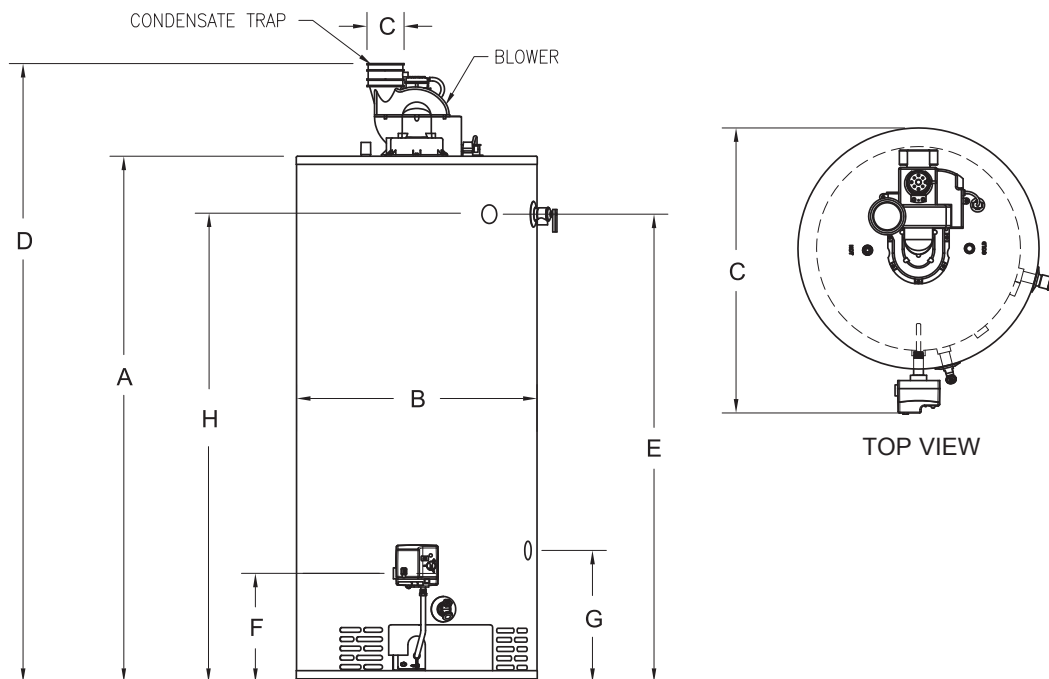

	Natural Gas			LP Gas			1st											Vent	Ship.
Model Number	Cap. Gal.	Btu/hr Input	GPH @ 90°F Rise	Btu/hr Input	GPH @ 90°F Rise	Gal.	Energy Factor	A	B	C	D	E	F	G	H	Size	Wt.		
LVN041G	40	40,000	43	38,000	41	69	0.62	46-1/2"	20"	25"	58-1/2"	40-1/2"	11-3/4"	-	-	2"	166		
LVN051G	50	40,000	43	38,000	41	80	0.62	47-1/4"	22"	26-3/4"	58-1/2"	41"	11-3/4"	-	-	2"	185		
LVN052G †‡	48	67,000	72	60,000	65	102	0.65	56-1/2"	22"	26-3/4"	63-1/4"	50-1/4"	11-3/4"	13-1/2"	50-1/4"	3"	188		
LVN065G †‡	65	70,000	75	63,000	68	118	0.65	59-1/2"	24"	28-3/4"	66-3/4"	53-1/2"	11-3/4"	13-1/2"	53-1/2"	3"	222		
LVN076 †‡	75	76,000	82	75,500	81	135	N/A	59"	26"	31"	69-3/4"	51-3/4"	14"	16-1/2"	51-3/4"	3"	246		

Notes: Replace "N" with "L" to indicate LP gas model
 * indicates models with 2" of polyurethane foam insulation.
 † indicates side tapping for space heating.
 ‡ indicates no heat trap available

All water connections are 3/4" NPT.

All gas connections are 1/2".

Models fired above 75,000Btu/Hr are certified to ANSI Z21.10.3 and are not required to meet the NAECA or FVIR Standard
 Performance data is based on manufacturer test results.

Max. Vent Length (Total equivalent feet)

	2"	3"	4"
LVN041G	50	120	-
LVN051G	50	120	-
LVN052G	-	60	180
LVN065G	-	60	180
LVN076 (horizontal)	50	80	
LVN076 (vertical)	80	80	

FOR EASE IN ORDERING BY MODEL NUMBER

LV	N	041	G
Power Vented	Natural Gas	Gallon Capacity	FVIR

This is a Power Vented, residential, natural gas 40 gallon water heater.

Certified for Potable Water and Space Heating Applications

This water heater is suitable for water heating and space heating. Toxic chemicals, such as those used for boiler water treatment shall NEVER be introduced into this system. This water heater may NEVER be connected to any existing heating system or components previously used with non-potable water heating appliances.



Lochinvar Corporation • 300 Maddox Simpson Pkwy • Lebanon, TN 37090 • 615-889-8900/Fax: 615-547-1000
 www.Lochinvar.com