

SUBMITTAL DATA SHEET

NL Ball Style Corporation Stop – 74101B

AWWA/CC x Copper Flare

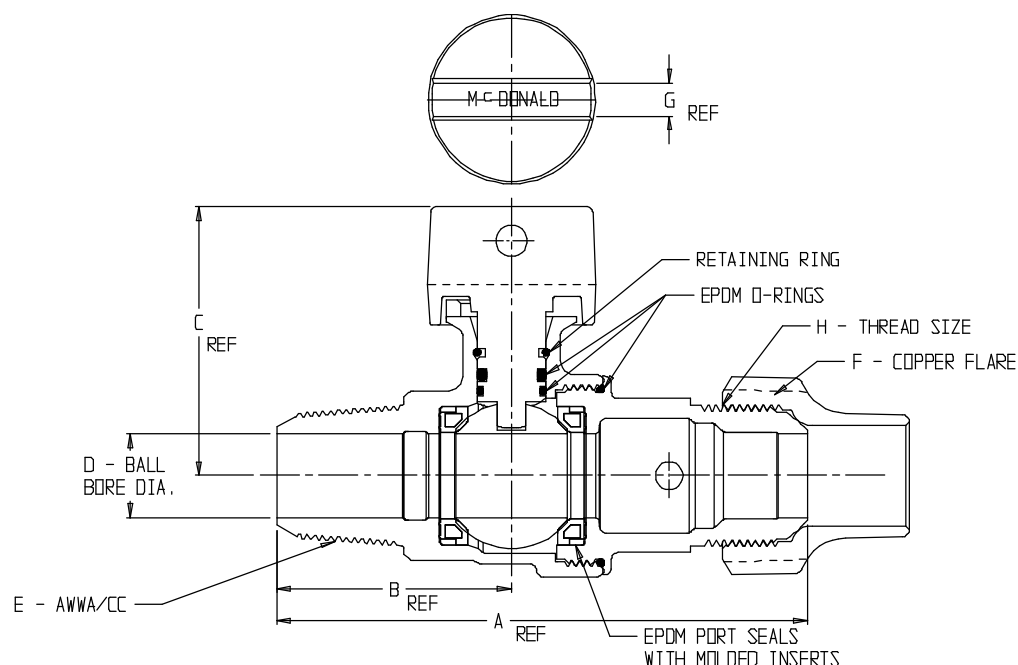

MODEL	SIZE	A	B	C	D	E	F	G	H
74101B	3/4	4.82	2.14	2.42	.75	3/4	3/4	.30	3/4 AWWA FLARE
74101B	1	5.48	2.59	2.65	1.00	1	1	.30	1 AWWA FLARE
74101B	1 1/2	6.79	3.05	3.40	1.50	1 1/2	1 1/2	.40	1 1/2 AWWA FLARE
74101B	2	8.80	4.32	3.71	2.00	2	2	.40	2 AWWA FLARE

SUBMITTAL INFORMATION

- Manufactured in compliance with ANSI/AWWA C800 (latest revision)
- Brass components in contact with potable water conform to ASTM B584, UNS C89833 (latest revision) and identified with “NL”
- Certified to NSF/ANSI 61 and NSF/ANSI 372
- Brass components not in contact with potable water conform to ASTM B62 and ASTM B584, UNS C83600 -85-5-5-5 (latest revision)
- PTFE coated brass ball rotates 90°
- Valve rated for 300 PSIG water pressure, end connections not to exceed rated pipe pressure.
- Blow out proof EPDM port seals
- End piece joint sealed with an EPDM o-ring and thread locker



A.Y. McDonald Mfg. Co.
P.O. Box 508
Dubuque, IA 52004-508

Toll Free: 1-800-292-2737
Fax: 1-800-832-9296
Hours: 7:00 a.m. – 5:00 p.m., CST

sales@aymcdonald.com
www.aymcdonald.com

A.Y. McDonald considers the information on this assembly drawing correct when published. Item and option availability, including specifications, are subject to change without notice.

Submitted by: